



Product Description

The KBC ESULS4-L1-B Series is a high performance, unmanaged industrial switch with 5* 10/100M auto sensing copper port, four of five copper ports support PoE/PoE+ which means each port offers a maximum of 30w power. The switch is rugged in design with an IP40 enclosure and industrial level 3 ESD protection. Unique mount design makes DIN mount and remove is quite easy. The rugged design makes it suitable for use in many harsh environment applications such as Power, Transportation, Pipeline, Petrochemicals, Industry automation and IP surveillance.



Product Features

- Unmanaged industrial switch
- 5*10/100M Base-T(X) ports
- 4 ports Supporting IEEE802.3af&at
- Redundant Power supply input
- Overload current protection and reverse polarity protection
- Level 3 ESD protection
- IP40 housing design
- Supporting DIN rail or wall-mounted
- Unique DIN mount design makes mounting and removal simple

Typical System Configuration

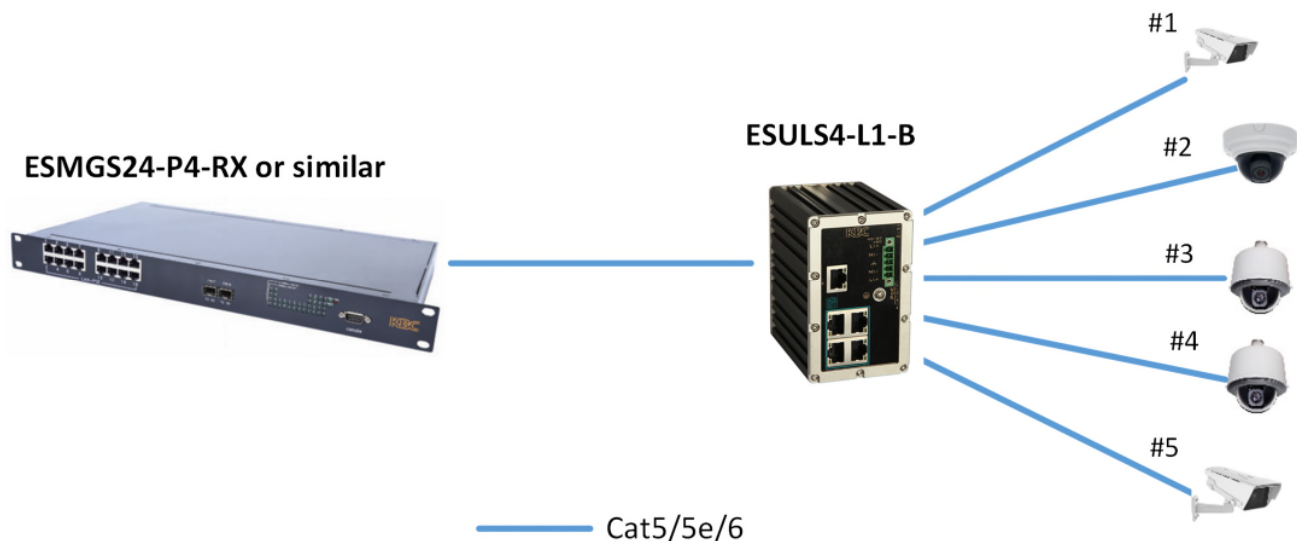

Specifications

Standards

IEEE Standards IEEE802.3, IEEE802.3u

Ports

10/100MBase-T 5, 4 ports with POE/POE+

Switch Performance

Architecture Store-and-forward
Buffer 512K
Switch Capacity 1Gbps

PoE

Standard 802.3af/at
PSE Type End-span
Power Pin Assignment 1/2(+), 3/6(-)
PoE Power Output up to 30 watts max per port

Power ⁽²⁾

Redundant Power Input 48 ~ 57Vdc
Power Consumption < 8W (No POE output)
PoE Budget 120W
Overload Current Protection Yes
Reverse Polarity Protection Yes

Environmental

Operating Temperature -40° ~ +75° C
Storage Temperature -40° ~ +85° C
Operating Humidity 5% to 95% non-condensing

Mechanical

Enclosure IP40
Dimension (WxDxH) 62mm × 86.5mm × 100mm
Weight 0.6kg

Protection

Surge 6KV, IEC61000-4-5
ESD Level 4: IEC61000-4-2
RS Level 3: IEC61000-4-3
EFT Level 4: IEC61000-4-4
CS Level 3: IEC61000-4-6

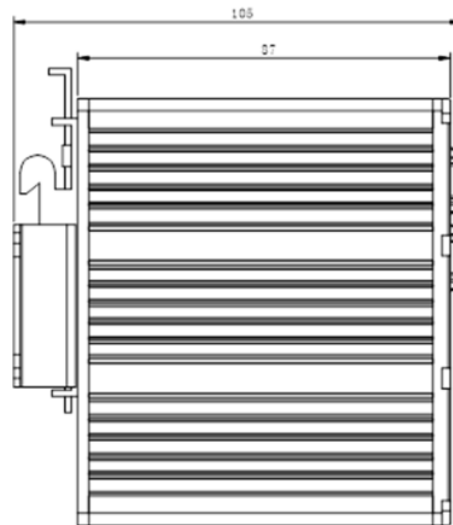
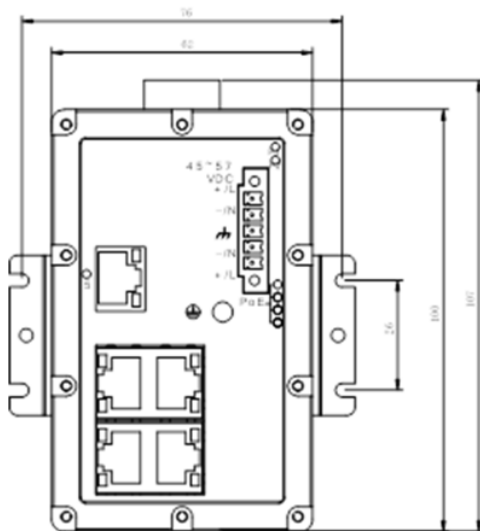

Order Information

ESULS4-L1-B: PoE+, Unmanaged, 4*10/100M Base-T PoE/PoE+, 1*10/100M Base-T

1. SFP module sold separately.
2. Power supply sold separately.

Due to ongoing technological improvements, product specifications are subject to change without notice. KBC is not liable for any errors, omissions or changes of any description of the goods contained herein. This information is for the sole purpose of identifying the products and KBC makes no warranty that the products conform to any description contained herein. Do not rely solely on any representations, statements, or assertions concerning these Products contained herein.